

Visitor Map

Woodman Lane
Clent
Stourbridge
West Midlands
DY9 9PB
Tel: 01562 882253
Fax: 01562 883856
sunfield@sunfield.org.uk
www.sunfield.org.uk

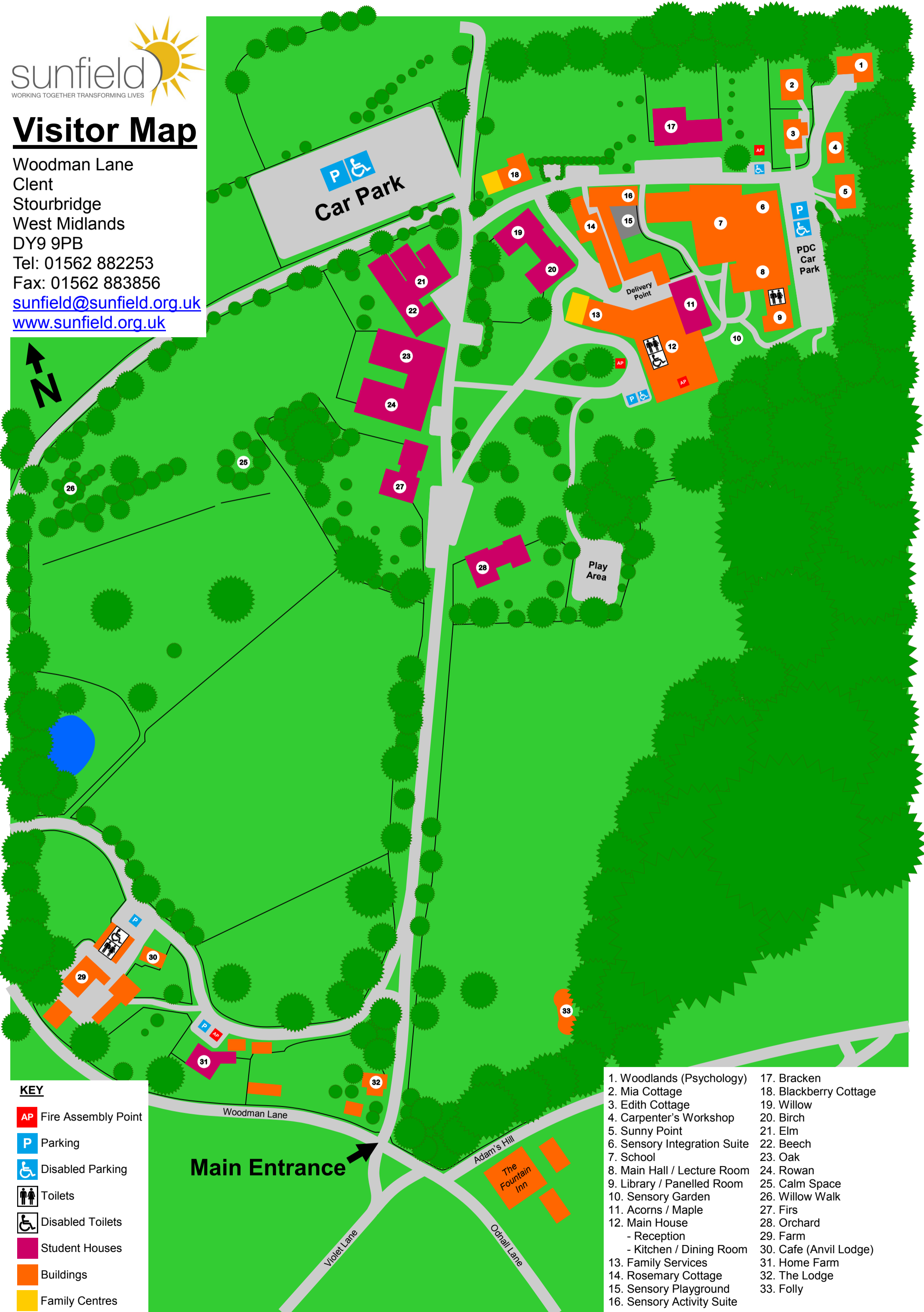

KEY

- AP Fire Assembly Point
- P Parking
- ♿ Disabled Parking
- ♿ Toilets
- ♿ Disabled Toilets
- Student Houses
- Buildings
- Family Centres

- | | |
|--|------------------------|
| 1. Woodlands (Psychology) | 17. Bracken |
| 2. Mia Cottage | 18. Blackberry Cottage |
| 3. Edith Cottage | 19. Willow |
| 4. Carpenter's Workshop | 20. Birch |
| 5. Sunny Point | 21. Elm |
| 6. Sensory Integration Suite | 22. Beech |
| 7. School | 23. Oak |
| 8. Main Hall / Lecture Room | 24. Rowan |
| 9. Library / Panelled Room | 25. Calm Space |
| 10. Sensory Garden | 26. Willow Walk |
| 11. Acorns / Maple | 27. Firs |
| 12. Main House
- Reception
- Kitchen / Dining Room | 28. Orchard |
| 13. Family Services | 29. Farm |
| 14. Rosemary Cottage | 30. Cafe (Anvil Lodge) |
| 15. Sensory Playground | 31. Home Farm |
| 16. Sensory Activity Suite | 32. The Lodge |
| | 33. Folly |